



LOCATION PLAN (1:1250 @ A3)

A. 01/04/2020 Boundary confirmed
 Rev. Date Amendment

THIS DRAWING MUST NOT BE REPRODUCED WHOLLY OR
 IN PART WITHOUT PRIOR PERMISSION © SPUD ARCHITECTS LTD

19 TOMS LANE, KINGS LANGLEY,
 HERTFORDSHIRE. WD4 8NA
 PROPOSED HOUSING

SpUd Architects Ltd

for
 MRS W TWYMAN

14 Abbots Road Abbots Langley Hertfordshire WD5 0AZ
 Tel: (01923) 275131 Mob: 07527 620842 Email: info@spudarchitects.co.uk

Drawing Title

Drawing No. **1232 / SK101A**

EXISTING SITE PLAN

Scale: 1:1250 @ A3

Date: MARCH 2020



THIS DRAWING MUST NOT BE REPRODUCED WHOLLY OR IN PART WITHOUT PRIOR PERMISSION © SPUD ARCHITECTS LTD

Rev. Date Amendment
 19 TOMS LANE, KINGS LANGLEY,
 HERTFORDSHIRE. WD4 8NA
 PROPOSED HOUSING

SpUd Architects Ltd

for
MRS W TWYMAN

14 Abbots Road Abbots Langley Hertfordshire WD5 0AZ
 Tel: (01923) 275131 Mob: 07527 620842 Email: info@spudarchitects.co.uk

Drawing Title

Drawing No. **1232 / SK210**

POTENTIAL SITE PLAN

Scale: 1:500 @ A3

Date: MARCH 2020



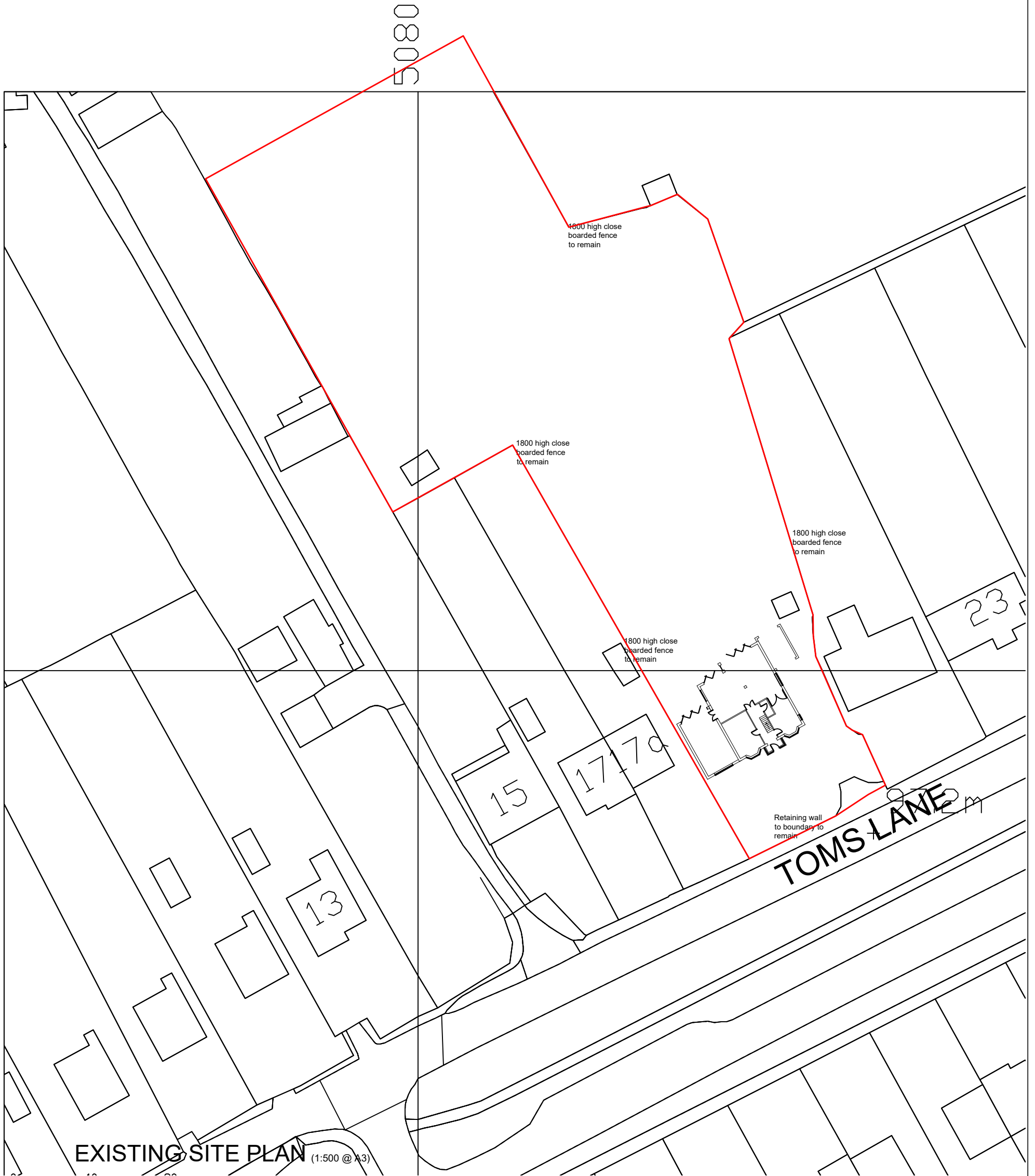

EXISTING SITE PLAN (1:500 @ A3)

B. 01/04/2020 Boundary confirmed
 Rev. Date Amendment

THIS DRAWING MUST NOT BE REPRODUCED WHOLLY OR
 IN PART WITHOUT PRIOR PERMISSION © SPUD ARCHITECTS LTD

19 TOMS LANE, KINGS LANGLEY,
 HERTFORDSHIRE. WD4 8NA
 PROPOSED HOUSING

SpUd Architects Ltd

for
 MRS W TWYMAN

14 Abbots Road Abbots Langley Hertfordshire WD5 0AZ
 Tel: (01923) 275131 Mob: 07527 620842 Email: info@spudarchitects.co.uk

Drawing Title

Drawing No. **1232 / SK100B**

EXISTING SITE PLAN

Scale: 1:500 @ A3

Date: MARCH 2020

