

# Bishops Wood Country Park

## Summary of Proposals

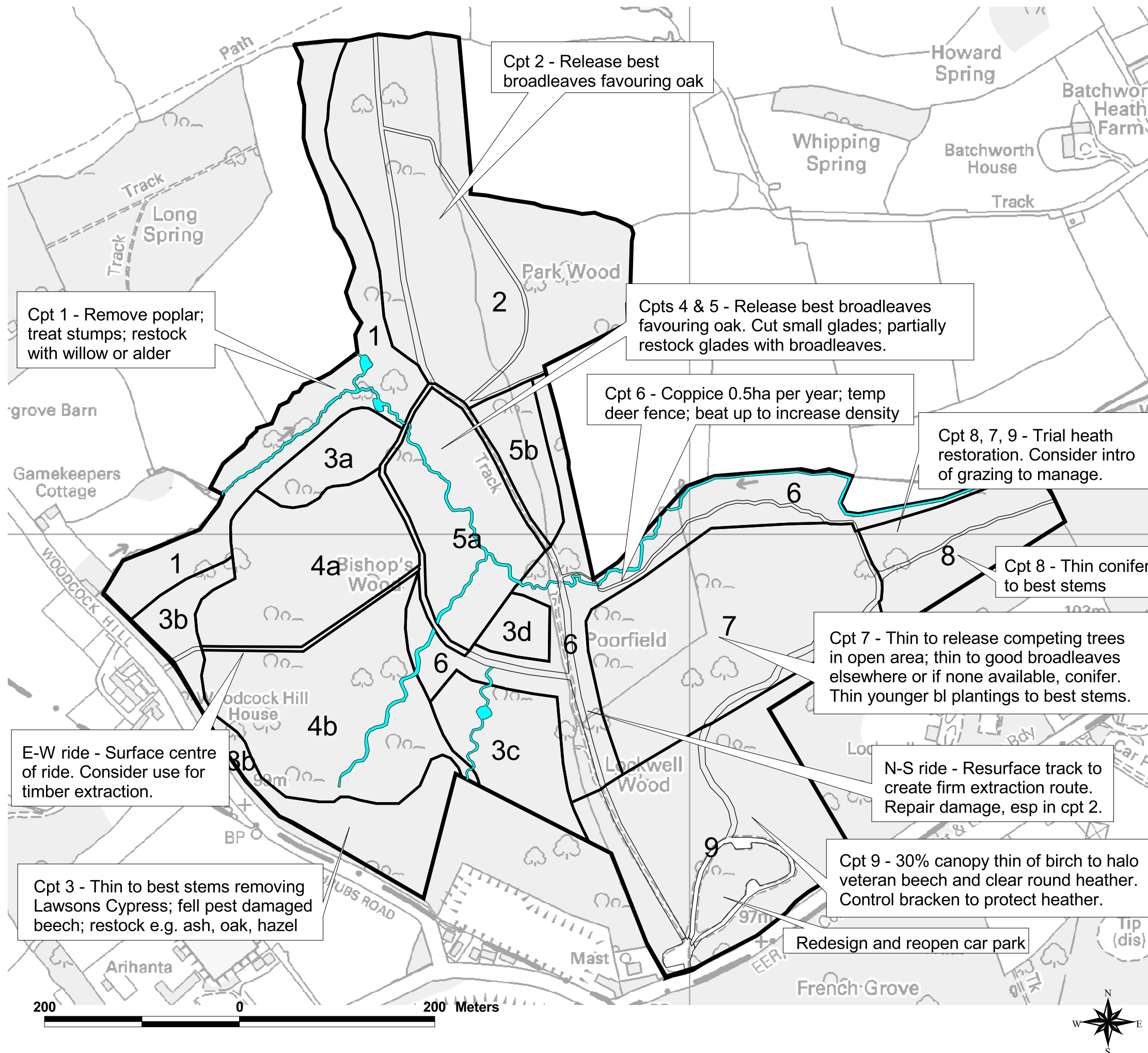

### General Proposals

- Baseline Ecological Survey
- Programme of halving and recutting of selected veteran stubbs
- Eradicate invasive exotic species
- Open up along water courses, retaining some shade to protect rare species. Restore pond.
- Install welcome signs
- Upgrade access furniture
- Replace interpretation with new including info on restoration plans
- Formalise arrangements for route of London LOOP incl links to PROW
- Review and consider extending access for horse riders and introduce riders code of conduct.
- Maximise opportunities for public participation in woodland management

1:4000

© Crown copyright and database rights 2012  
Ordnance Survey 100019606. Use of this data is subject to terms and conditions. You are not permitted to copy, sub-licence, distribute or sell any of this data to third parties in any form. (This restriction may not apply to HCC and its licenced contractors agents and partners.)

